

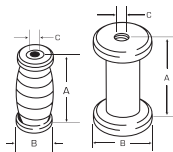

## SLIDE HAMMER



Product #	Description	Height (in) (A)	Outside Diameter (in) (B)	Hole Diameter (in) (C)
<b>J4260H</b>	2-1/2 lbs Slide Hammer	4	2	5/8
<b>J4055H</b>	5 lbs Slide Hammer	5-5/16	3-1/4	5/8



## T-HANDLE SLIDE RODS

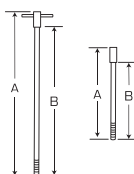

Product #	Description	Length (in) (A)	Thread Length (in) (B)	Shaft Diameter (in)	Thread
<b>J4260R</b>	Slide Rod	24	22	9/16	5/8"-12 Acme
<b>J4275R</b>	Short Slide Rod	12-3/4	10-3/4	9/16	5/8"-12 Acme



## FORCING SCREW

► Used with No. J4280S.

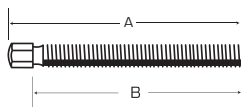

Product #	Description	Length (in) (A)	Thread Length (in) (B)	Hex (in)	Thread	Tip
<b>J4205S</b>	Forcing Screw	6-1/4	5-5/8	9/16	5/8"-12	Drilled for Replacement Tips J4022T and J4022TS
<b>J4225S</b>	Forcing Screw	10-1/4	9-1/4	3/4	3/4"-12	J4012T
<b>J4235S</b>	Forcing Screw	12	11-1/16	1/2	3/4"-12	J4012T



## REAR AXLE FLANGE FOOT

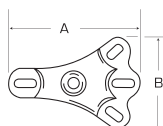

Product #	Description	Length (in) (A)	Width (in) (B)	Shaft Diameter (in)	Thread
<b>J4277B</b>	Rear Axle Flange Foot	6-3/4	4-5/8	5/8	5/8"-12

